



IMPORTANT

Before using your Infinity Wick Votive Candles, please make sure that you carefully read through these instruction sheets.

NOTE: The important safeguards and instructions that appear in this manual are not meant to cover all possible conditions and situations that may occur. It must be understood that common sense, caution and care are factors that can't be built into any product. This approach must be used by the person(s) caring for and operating the candles.

GENERAL INFORMATION

Battery installation should only be performed by an adult. Keep all batteries away from children. Only batteries of the same or equivalent type as recommended should be used. Battery leakage can cause corrosion and damage to this product so please remove non-functioning batteries immediately. Remove the batteries from product during long periods of non-use. DO NOT DISPOSE OF IN FIRE. Please dispose at your local recycling facility.



MODEL NO.

LC005351

WHAT WE PROVIDE

- 4 x Infinity Wick Ivory Votive Candles
- 6-Button Remote Control

WHAT YOU WILL NEED

- 4 x CR2450 Batteries (1 per candle)
- 2 x AAA Batteries for Remote (Optional)

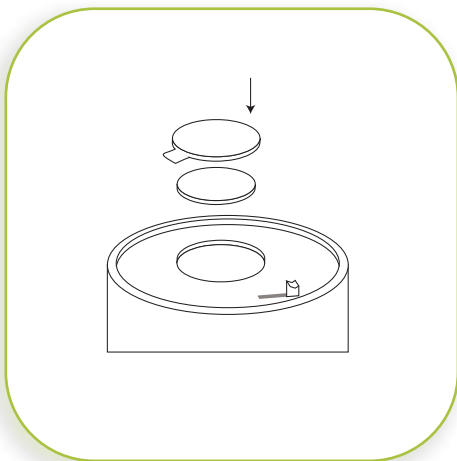

1

BATTERY INSTALLATION

Each candle works with 1 x CR2450 Batteries. The battery compartment is located on the bottom of the candles. Open the battery compartment. Batteries should be inserted with the correct polarity as indicated (+/-) and battery compartments secured before use.

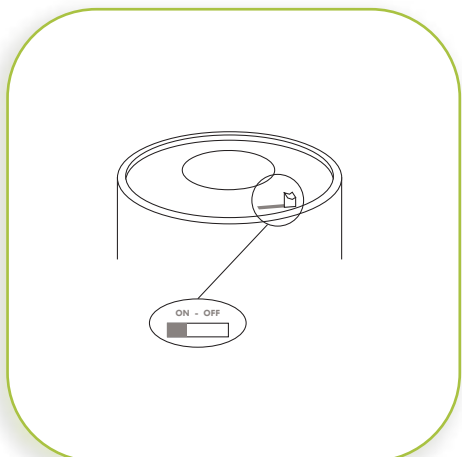

2

ON/OFF

Push the button on the base of the candle to switch on and off. To maximize battery life, turn the candle off during long periods of non-use.

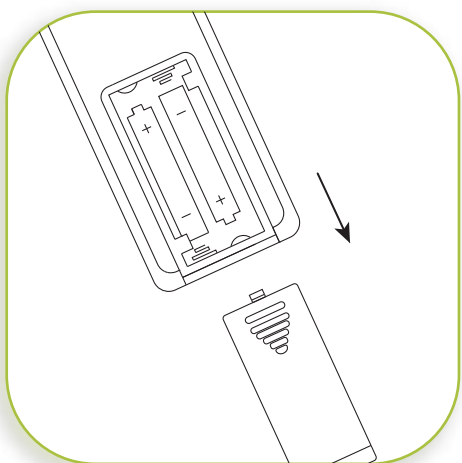

3

INSTALLING THE REMOTE BATTERY

This remote works with 2 x AAA batteries. The battery compartment is located on the back of the remote. To open, slide the cover down. Batteries should be inserted with the correct polarity as indicated (+/-). Slide the cover back on to secure before use.

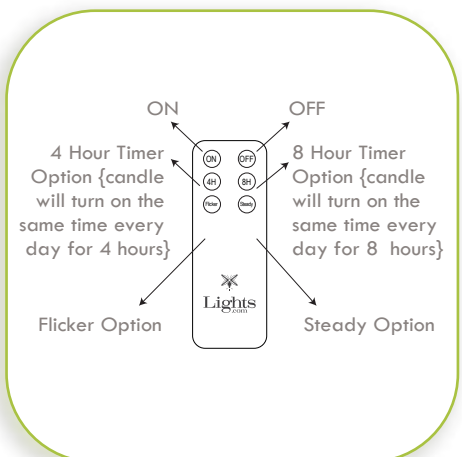

4

REMOTE FUNCTIONS

The candle(s) must be manually turned on in order for the remote control to function. There are six functions on the remote (see diagram).